

THIS DRAWING / DESIGN IS STRICTLY CONFIDENTIAL & THE
 COPYRIGHT THEREIN THE EXCLUSIVE PROPERTY OF
MOBILE CLIMATE CONTROL INC.
 AND MAY NOT BE USED OR COPIED OR EXHIBITED WITHOUT
 THEIR WRITTEN PERMISSION.

SPECIFICATION:

COOLING - 51,000 BTU/HR @ 95°F
 ENTERING AIR TEMPERATURE.
 HEATING - 68,000 BTU/HR @ 150°F T.D.
 AND 7.2 GPM COOLANT FLOW
 AIR FLOW - 600 CFM (UNIT ONLY)
 CURRENT - 17.8 AMPS @ 27V (MAX.)

CASING MADE OF 18GA CRS AND
 FINISHED IN BLACK SEMI GLOSS
 EPOXY POWDER COAT.

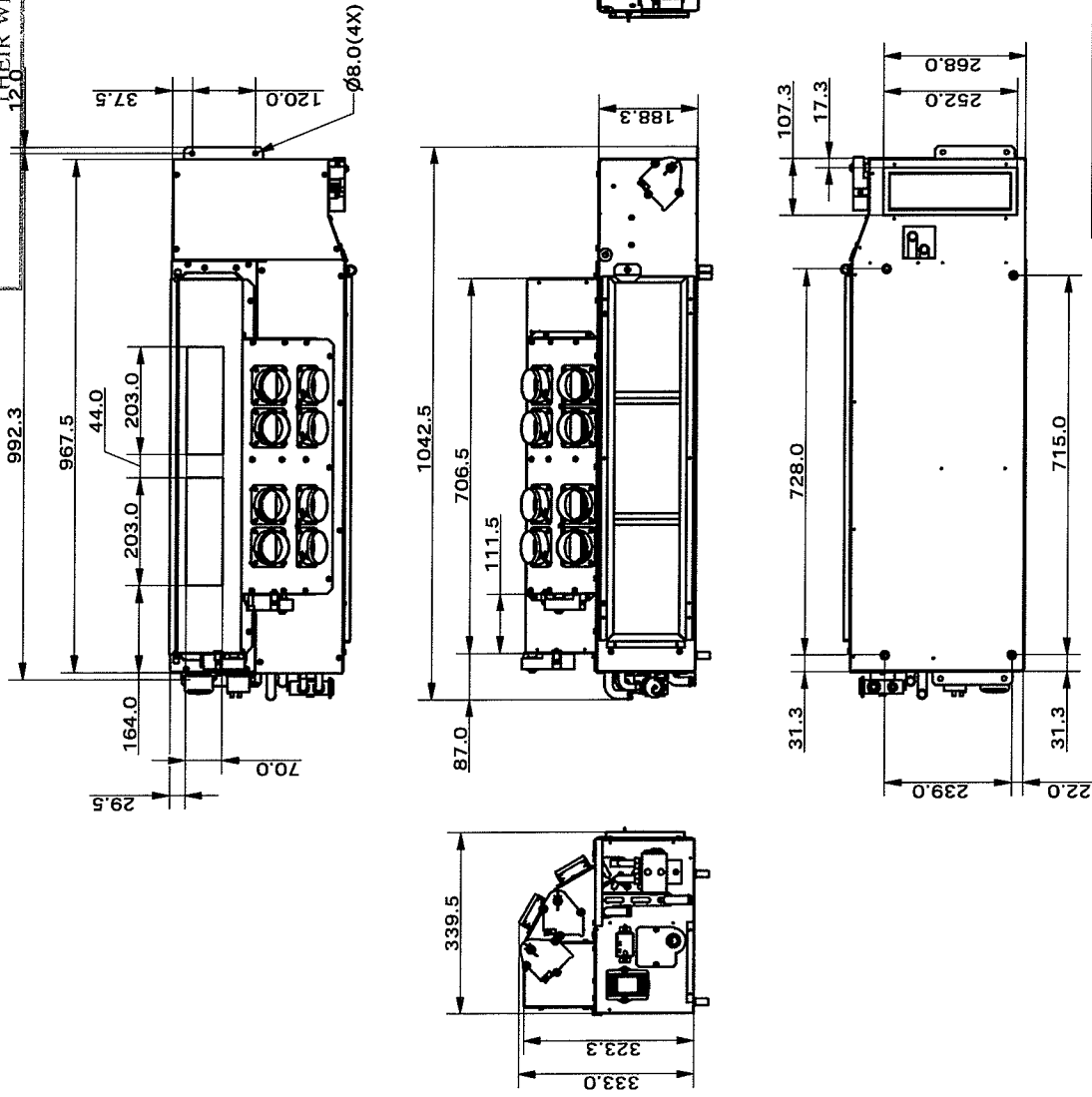

CUSTOMER:
 BLUE BIRD CORPORATION
 P/N 0090255

SYMBOL		PART NO.		DESCRIPTION	
MCC 37		13 - 14206		HEATER A/C 24V	
SCALE: NTS		BY: BV		DATE: 6/29/2005	
CHECKED:		DATE:		DWG: 13 - 14206...icdwo	
METRIC				Mobile Climate Control Inc. Toronto - Ontario - Canada	
TOLERANCE UNLESS OTHERWISE SPECIFIED ANG 0.6 3 8 30 150 315 1000 3 6 30 120 315 1000 2000 ±1 ±0.15 ±0.2 ±0.5 ±0.8 ±1.2 ±2 ±3 ±4		OVER 2000 ±4		THIS PRINT IS PROVIDED ON A RESTRICTED BASIS AND IS NOT TO BE USED IN ANY WAY DETRIMENTAL TO THE INTEREST OF MOBILE CLIMATE CONTROL	
SYMBOL	DESCRIPTION	DATE	BY	REVISION	